

Removing and Installing IO Cards to PR Series recorders

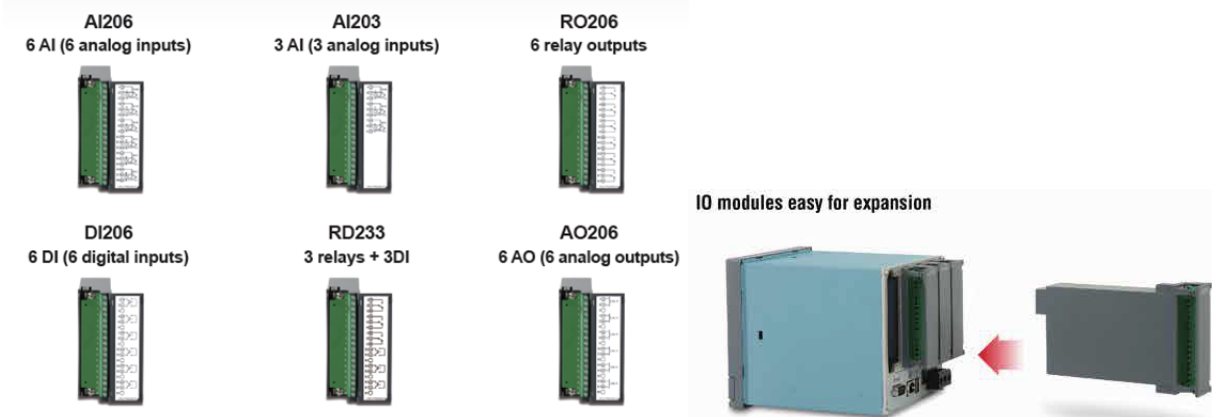

Review the directions and graphics below; failure to do so will damage the IO Card.

The IO Cards should not be Removed or Inserted to the PR when the Power is ON.
 This should only be done when the recorder power is OFF.

Removing an IO Card

- First remove the metal screws then the plastic screws
- Press the lock on the top and bottom of the Card and pull to remove it.

Installing an IO Card

- Slide the card into the slot
- Insert the plastic then the metal screws.
- The Maximum Torque for the
 - metal screw is 3Kg-cm (2.6in-lb)
 - plastic screw is 0.8Kgf-cm (.7in-lb)

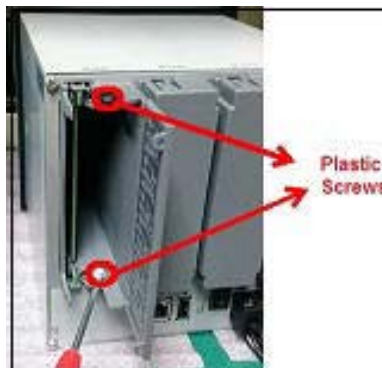
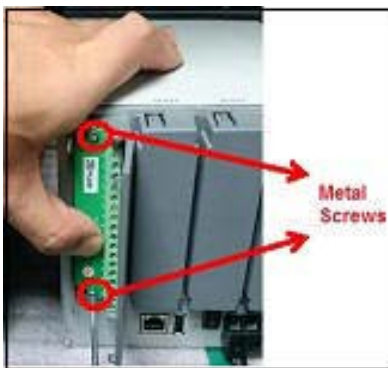

PR30 Note: Analog Input card(s) should be

- Inserted **ONLY** in slots 1 to 8.
- Should not be inserted into slots 9 to 16.

Future Design Controls
 Technical Support: 866-342-5332
support@futuredesigncontrols.com